

# iQ Meter



## Smart filter management for maximum service efficiency and reliability.

The BRITA iQ Meter is an intelligent solution designed for coffee, vending and gastronomy businesses seeking a simple and cost-effective way to remotely monitor their filter portfolio and optimize service efficiency. By enabling precise filter replacement scheduling based on actual water consumption, the iQ Meter ensures that filters are replaced at the right time, reducing the risk of machine downtime and ensuring optimal filter performance. With seamless integration into the BRITA iQ Portal, the system provides a real-time overview of all connected filters, allowing service visits to be planned efficiently and reducing the need for on-site capacity checks. The iQ Meter is compatible with all PURITY C and PURITY filters.

BRITA iQ Meter - for smarter service efficiency, real-time monitoring and simple filter management.

## The benefits to you

- Battery powered - up to 5 year battery lifetime\* (replaceable battery)
- Plug and play mobile network connection (4G)
- Compatible with all BRITA PURITY C and PURITY systems
- Fully integrated in the BRITA iQ Portal



\* External factors such as low temperatures and poor network reception may reduce battery lifetime.

The iQ Meter will be integrated seamlessly in the existing BRITA iQ Portal, providing a centralized overview of all connected filter systems:



Remaining lifetime



Remaining capacity



Last week's water consumption



Last activity

# BRITA iQ Meter integrates any BRITA PURITY C and PURITY system in the iQ Portal

## Real-time filter insights for smarter, hassle-free service planning

BRITA iQ Meter seamlessly integrates any BRITA PURITY C and PURITY system in the iQ Portal, offering real-time insights into all connected filters. This allows efficient service planning and reduces the need for on-site capacity checks.

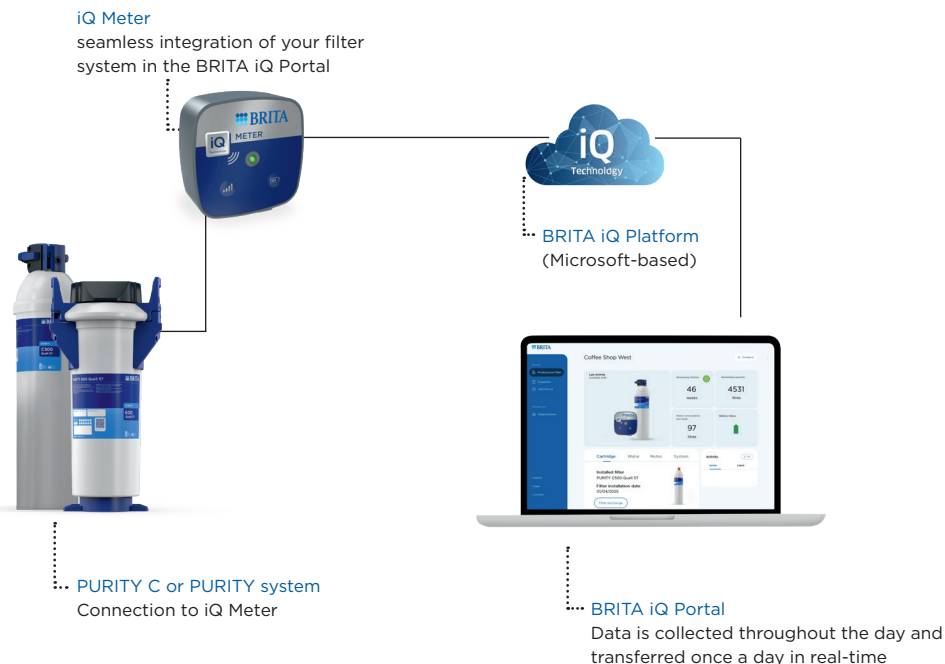

Technical data	FlowMeter 10-100	FlowMeter 100-700
Communication Unit	80 x 80 x 32 mm	
Sensor	80 x 50 x 26 mm	97 x 50 x 33 mm
Orientation	horizontal / horizontal / horizontale / orizzontale / horizontal	
Flow range	10 - 100 l/h	100 - 700 l/h
Deviation	+/- max. 5%	
Operating pressure	max. 8.6 bar	
Pressure loss	100 l/h: ca. 0.3 bar	700 l/h: ca. 1.1 bar
Intake temperature drinking water	4 - 30 °C	
Intake temperature not drinking water	-	4 - 60 °C
Ambient temperature	4 - 40°C	0 - 60 °C
Battery	3.6 V AA Lithium Battery (e.g. Fanso ER14505M)	
Degree of protection communication unit	IPX4	
Degree of protection sensor	IPX8	
Cable length	max. 1.5m	
Inlet connection	G 3/8" Union nut	G 3/4" with o-ring seal
Outlet connection	G 3/8"	G 3/4" Union nut

For more information please contact:

### BRITA Water Filter Systems Ltd.

BRITA House | 9 Granville Way | Bicester | OX26 4JT | United Kingdom  
Tel.: +44 844 742-4990 | Fax: +44 186 936-5962  
clientservices@brita.co.uk | www.brita.co.uk

### Headquaters: BRITA SE

Heinz-Hankammer-Straße 1 | 65232 Taunusstein | Germany  
Tel.: +49 6128 746-0 | Fax: +49 6128 746-5033  
info@brita.net | www.brita.net

## BRITA Recycling Program

Environmental protection and recycling are part of the BRITA corporate philosophy. As early as 1992, we established a recycling programme for our filter cartridges – the first in our industry. Our plant in Taunusstein, Germany, processes cartridges from both the hospitality industry and private households.



Learn more about the BRITA Recycling program:  
[brita.co.uk/recycling-professional](http://brita.co.uk/recycling-professional)