



BRITA WATER DISPENSER FOR HOME | 5.3 L



EN INSTRUCTION MANUAL

Important Safety Instructions

Please read the safety instructions carefully before using the appliance. Keep this manual safe for future reference and make sure to pass it on to future owners of the appliance. BRITA bears no liability in any case the instructions in the manual are not correctly followed.

The appliance is intended for use in domestic and similar applications such as staff kitchens in shops, offices and other work environments, farmhouses, customers in hotels, motels and other residential settings, Bed and breakfasts. It should not be used for commercial purposes.

Residual risk

Please place this water dispenser in a shady, wind-protected, stable and flat place. Keep it away from other heat sources. Do not place the BRITA MAXTRA PRO water filter in direct sunlight, but store it in a dark, cool and dry place and keep new water filters in their original packaging until you are ready to use them. Please clean the appliance only in accordance with the instructions in section 8: 'Maintenance'

The MAXTRA PRO water filter's material is specially treated with silver. As a result, trace amounts of silver may be released into the water; however, these levels remain well below the limits set by the World Health Organization (WHO).

Sensitive to potassium? Filtering initially causes a slight elevation in the potassium content of the water. This is harmless (e.g. 1 L of BRITA filtered water contains less potassium than an apple). Please consult your doctor before using a BRITA water filter if you suffer from kidney disease or have to

follow a special low potassium diet.

Natural traces

The BRITA activated carbon beads are of natural origin, natural variations may occur. If you discover carbon particles in your filtered water, rinse the water filter until there are no more particles visible. These particles are not harmful to your health since they pass through the body unchanged when swallowed.

Store filtered water in a cool place and use within 24 hours. Official advice for boiling tap water also applies to BRITA filtered water. The rule is: filter first, then boil! If this advice no longer applies, please clean the water dispenser thoroughly and insert a new water filter.

For certain groups of people (e.g. babies and people with impaired immunity) it is generally recommended that tap water should be boiled.

If the water filter has not been used for a while, remove it, empty the tank and replace the water filter loosely in the empty funnel.

The following section specifies residual risks that may occur even if the water dispenser is used as intended.

WARNING



Danger to life due to electric current! Contact with electrical components poses an immediate danger to life due to electric shock. Damage to the insulation or individual components can therefore be life-threatening. If the insulation is damaged, disconnect the power supply immediately and arrange for repairs. Never bypass or

switch off fuses. Do not immerse the appliance fully in water.

1

Keep electrical components away from moisture to avoid the risk of a short circuit. Avoid spillage on the connector. Never pull the plug by the cable or with wet hands. Always position the cable so that it does not come into contact with heat sources, moisture, oil, sharp objects, sharp edges, etc. Do not pinch or kink the cable. If the mains cable is damaged, it must be replaced by the manufacturer, its customer service centre or a similarly qualified person in order to avoid a potential hazard.

Ensure that the plug remains easily accessible so that the appliance can be disconnected from the mains. The appliance and its accessible parts become hot during use. Take care not to touch the heating elements. Make sure to keep a distance of 20 cm to any object or wall around the appliance to ensure heat dissipation. Any use beyond the intended purpose or other types of use are considered as misuse. Misuse can cause potential damage.

Unplug the appliance before cleaning or doing maintenance work. Make sure that the user can check whether the appliance is still disconnected from the mains during the cleaning process. Refer to section 8: 'Maintenance, Cleaning'.

The appliance is to be supplied through a residual current device (RCD) with a rated residual operating current not exceeding 30mA.

This appliance is not intended for use by persons (including children) with reduced physical, sensory or mental capabilities, or lack of experience and knowledge, unless they have been given supervision or instruction

concerning use of the appliance by a person responsible for their safety. This appliance can be used by children aged 8 years and above if they have been given supervision or instruction concerning use of the appliance in a safe way and if they understand the hazards involved. Cleaning and user maintenance shall not be carried out by children unless they are older than 8 and supervised. Keep the appliance and its cord out of reach of children aged less than 8 years. Children should be supervised to ensure that they do not play with the appliance or get scalded.

Appliance contains a UV-C emitter.

WARNING



Do not operate the UV-C emitter when it is removed from the appliance enclosure. Unintended use of the appliance or damage to the housing may result in the escape of dangerous UV-C radiation. UV-C radiation may, even in little doses, cause harm to the eyes and skin. Appliances that are obviously damaged must not be used. Do not replace the UV-C emitter.



Danger from hot water and hot steam: Be careful when dispensing water above 45° C.

Ensure that there are no extremities under the water outlet.

WARNING



Keep all ventilation openings in the appliance enclosure or in the structure for building-in clear of obstructing.

Do not use mechanical devices or other means to accelerate the defrosting process, other than those recommended by the manufacturer.

Do not damage the refrigerating circuit.

Do not store explosives, such as ignition aerosols, in the appliance.
Do not place a portable multi-position

socket or portable power source on the back of the appliance.

Icons used



Danger! Flammable materials. Risk of fire.



Complies with the requirements of CE labelling



Danger! Risk of burns due to hot steam!



Read the manual carefully and keep it for future use.



Caution! Risk of injury and damage to property.

Technical data*

Model name:	WS2.0B, WS2.0W
BRITA MAXTRA PRO water filter Limescale Expert	Lifetime: 4 weeks Capacity: 150 L
Inlet water pressure	0-0.5 MPa
Nominal power	2200 W
Heating power	2100 W
Rated voltage/frequency	230 V-/50 Hz
Applicable water temperature	5 - 38 °C
Incoming water	Municipal tap water
Dispensing mode	9.5 W-2200 W
Standby mode	3 W
Tank volume	4.3 L
Volume of the funnel	1.8 L
Working temperature	4 °C - 40 °C
Refrigerating substance	R 600a (Isobutan, C ₄ H ₁₀), 18 g
Max. internal pressure	0.1 MPa

* valid only for the UK market. For technical data of your local market please refer to the respective language section.

4 Product Components

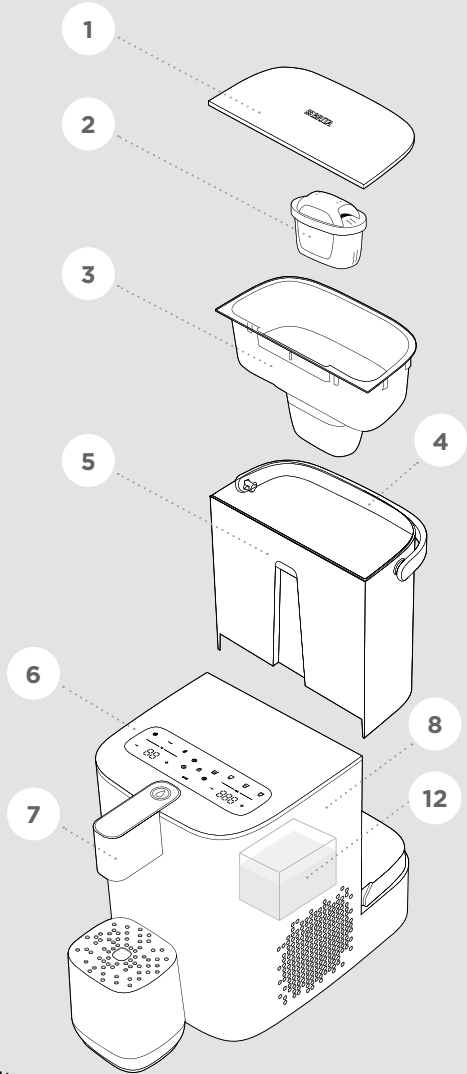
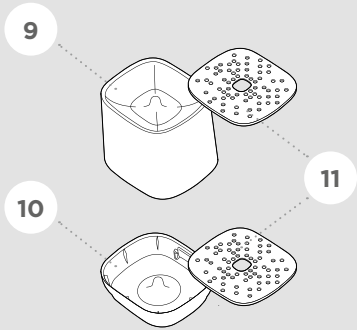

- 1 Lid
- 2 BRITA MAXTRA PRO water filter
- 3 Funnel
- 4 Handle
- 5 Water tank
- 6 Touch display
- 7 Water outlet
- 8 Base
- 9 Drip tray large
- 10 Drip tray small
- 11 Drip tray grids
- 12 Cold water tank inside, 1 L

Before first usage

Open packaging and take all system parts out. Place the appliance on a flat, stable surface to ensure correct operation and safety. Clean the appliance as described in Section 8: 'Maintenance'.

Keep your water dispenser upright about 3 hours before first use to avoid damaging the cooling system, if it was not kept upwards during the transport.

Touch display and functions



Touch Display

1 Temperature -

2 Temperature

3 Temperature +

4 Volume -

5 Volume / Error codes

6 Volume +

7 Volume large

8 Volume medium

9 Volume small

10 Hot

11 Ambient

12 Chilled

 Water dispensing

 Child lock

 Empty tank

 Filter exchange

 Innertube flushing

 Cold water tank flushing

 UVC indicator

6 Temperature Setting

(5 °C, ambient, 45 °C, 70 °C, 85 °C, 95 °C)

1  Decrease

or

3  Increase

Preset buttons:

12  Chilled: 5 °C

11  Ambient

10  Hot: 95 °C

Volume Setting

(150/ 250/ 350/ 450/ 550/ 650/ 750/ 900 ml)

4  Decrease

or

6  Increase

Preset buttons:

9  Small: 150 ml

8  Medium: 350 ml

7  Large: 900 ml

Water dispensing



The water dispensing button illuminates in different colours to indicate the selected water temperature:

Blue: 5 °C

White: Ambient, 45 °C

Red: 70 °C, 85 °C, 95 °C

Water dispensing **can also be stopped manually by pressing any button** on the touch display.

Initial setup



Power on

Plug the appliance into a suitable mains socket (see technical data). Switch on by **pressing the power switch on the back**. The display flashes for 3 seconds and then switches into standby mode. The child lock icon and the empty tank icon will light up, the cold water icon and the automatic self-cleaning icons will be flashing.

BRITA MAXTRA PRO Water Filter

1. Preparing:

Fill the clean tank with cold tap water. Immerse the **BRITA MAXTRA PRO water filter** and shake slightly to remove any excess air. Remove the water filter and pour away the water in the tank.

2. Inserting:

Insert the funnel into the tank and place the **BRITA MAXTRA PRO water filter** firmly in the funnel. If the water does not flow through, push the water filter further downwards.

3. Filling the tank

Always fill the funnel with cold tap water. Only tap water from water treatment plants may be used – only this meets the legal requirements for drinking water quality. The water in the funnel is filtered automatically and flows into the tank and from there inside the appliance.

4. Activating the MAXTRA PRO water filter

For optimal taste and performance please allow two full funnels of tap water to pass through the filter before drinking. To join BRITA in considering the environment, you can use this filtered water for your plants.



Child lock

Press and hold the child lock icon for 2 seconds to unlock the appliance. The child lock button turns off, volume, temperature and water dispensing buttons light up.

How to use

1. Run the automatic self-cleaning program: before first use, the inner pipe flushing icon and the cold water tank flushing icon will start flashing. Activate the automatic self-cleaning program as described in section 8: 'Maintenance, Cleaning and Automatic self-cleaning'.

2. Set your temperature and volume: Adjust the temperature and the volume to your preference using the preset buttons or the +/- buttons. For more details refer to section 6: 'Touch display and functions'. Note: The appliance always displays the last setting used.

3. Dispense your water:

Press the water dispensing button and enjoy your drink.

Note:

To ensure the optimal performance of your water dispenser for home and its features—such as filter exchange reminder and cleaning programmes—BRITA recommends keeping the appliance switched on at all times. It's also possible to switch off the cooling system permanently for extended periods or set a timer. For more details, please refer to the respective section in the user manual.

UV-C indicator



The **UV-C indicator** flashes slowly when the UV-C LED is active. It remains on during water dispensing and while the cleaning programs are running.

Empty tank icon



Icon lights up

when the water level is low. The water dispensing will stop once the level drops to 100 ml, but cold water can still be dispensed up to 1 litre.

Icon flashes

when the tank is removed or not installed correctly.

Cold water icon



If **the icon flashes** (when chilled water is selected), it indicates that the cooling system is in operation and **dispensing of cold water is not possible**. The icon will continue to flash when the appliance is in standby mode. Once the water reaches the selected temperature, the **icon will light up** and cold water will be available for dispensing.

Cold water temperature pre-setting

The default cold water temperature is set to 5 °C. You can adjust it to 10 °C as follows:

1 Press the **cold water button** and the **volume “-” button for 3 seconds**, the current temperature appears on the display.



2 Press the **temperature “-” or “+” button** to switch between 5 °C and 10 °C.



3 Press the **cold water button** and **volume “-” button for 3 seconds** to confirm the setting.



Cooling system on/off

Permanent Setting

If the cooling function is not used for an extended period of time we recommend to turn off the cooling system and empty the cold water tank.

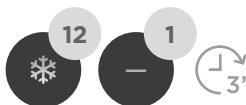

Ensure the child lock is unlocked. Press and hold the **cold water button** and the **temperature “-” button for 3 seconds** to turn the cooling system permanently off. The dispensing button will start flashing in blue. Press the dispensing button to empty the cold water tank inside the appliance. Place a sufficiently large container (at least 1L) under the outlet.



To turn the cooling system on again, press and hold the **preset button “hot”** and **temperature “+” button for 3 seconds**.

If the cooling system was turned off **for more than 24 hours** and will be turned on again, the cold water tank flushing icon will be flashing on the display. Activate the cold water tank flushing as described in section 8: ‘Maintenance, Cold water tank flushing’.

Regular Setting/Setting the timer

You can set a timer when the cooling system should automatically turn off and on.

7



Enter the Time-Setting mode: unlock the child lock. Press and hold the **cold water button** and the **temperature '+' button** for **3 seconds**.

Set the Cooling System Turn-Off Time: the display will show 'off mode' (default setting) on the volume side, indicating that you need to set the time for the cooling system to turn off.



Select the Turn-Off Time: The temperature display will show **0-23**. Calculate the number of hours from the current time until you want the cooling system to turn off. Use the **temperature '-' or '+' buttons** to select the desired number of hours.



Set the Cooling System Turn-On Time: Press the **volume '-' or '+' button** to select the **'on' mode** and set the time for the cooling system to turn on.



Select the Turn-On Time: Enter the number of hours from the current time when you want the cooling system to turn on, using the **temperature '-' or '+' buttons**.



Save the setting: Press the **dispensing button** to save your settings.

Example: If the current time is 20:00, and you want the cooling system to turn off at 22:00 and turn on again at 7:00, follow these steps:

1. Enter the Time Setting mode as described above. 'Off mode' should appear on the volume side of the display.
2. Enter '2' (for 22:00) using the temperature '+' button.
3. Select the **'on'** mode using the volume '-'/'+' buttons.
4. Enter '11' (for 7:00) using the temperature '+' / '-' buttons.
5. Press the dispensing button to save the settings.



To disable the regular turn on/off mode, press and hold the cold water button and the highest temperature preset button for 3 seconds. You will hear a confirmation sound.

Note: If the device is turned off or unplugged, the timer will be deactivated and will need to be set up again.

Sound



A buzzer signal indicates that the activated operations have been carried out. To adjust the **sound level**: Press and hold the **volume “+” button** for **3 seconds** to enter the sound level adjustment mode. The **volume**

“+” button will begin flashing. Press the **volume “+”** to select between the sound levels **mute, low or high**. After approximately 10 seconds, the setting will be saved automatically.

Maintenance

Filter exchange



Your appliance reminds you automatically to replace the BRITA MAXTRA PRO water filter. The **filter exchange icon** lights up when either the specified time or the litre capacity of the BRITA MAXTRA PRO water filter have expired.

After **21 days / 112 L** the filter exchange icon will light up red indicating that you have 7 more days or 38 L until the replacement is due.

After **28 days / 150 L** the filter exchange icon will flash in red. Please exchange your BRITA MAXTRA PRO water filter now following the instructions in the section 7: ‘Initial setup, BRITA MAXTRA PRO water filter’.



After you have exchanged the MAXTRA PRO water filter press the filter exchange icon for 3 seconds and the light will turn off. The filter exchange reminder starts calculating the time and litres for the next exchange.

For a long life of your water dispenser appliance we recommend always using the BRITA MAXTRA PRO Limescale Expert water filter.

Activate filter exchange icon manually

You can reset the filter exchange reminder before the filter exchange icon lights up.

1. Replace the BRITA MAXTRA PRO water filter.
2. Unlock the appliance.



3. Press and hold the volume ‘-’ and volume ‘+’ button for 3 seconds, the filter exchange icon will light up.



4. Press and hold the filter exchange icon for 3 seconds to finish the setting.
5. The filter exchange icon turns off.

8 Cleaning

1. Automatic self-cleaning:

The automatic self-cleaning ensures the correct level of hygiene inside the appliance. Approx. 2.75 L of water are required for the whole cleaning process. To begin the cleaning, please make sure that the water tank contains enough water. Also, place a sufficiently large container under the outlet to collect the water. If the water runs out during the cleaning process, the appliance will pause and prompt you to refill the water tank. Once the tank is refilled, the cleaning procedure will resume until it is fully completed.

Cleaning cycles:

- before the 1st use
- after 90 days
- after unplugging or switching off the appliance



If the inner pipe flushing icon and the cold water tank flushing icon start flashing in red, press and hold both buttons for 3 seconds to start the process. Inner pipe cleaning will start first. Approx. 750 ml of water will be dispensed at various temperatures. The display will show '750' on the volume side, indicating the amount of water being flushed.

 **Danger from hot water and hot steam!**



During the entire cleaning process, the inner pipe flushing icon continues to flash red, the dispensing button lights up red and the UVC indicator flashes slowly. When the cleaning

process is completed (the inner pipe flushing icon stops flashing), cold water tank flushing starts automatically.



The cold water tank flushing icon starts flashing red and the dispensing button turns blue, UVC indicator flashes slowly. The display will show '2 L' on the volume side, indicating the volume of water being flushed. When the flushing program is finished, the flushing icon will no longer light up. The time for the next cleaning cycle is then recalculated.

2. Inner pipe flushing after 24 hours of non-use



The inner pipe flushing icon starts flashing red if hot and ambient temperature water has not been used for 24 hours. In this case, the temperature and the volume will be automatically set to 95°C and 350 ml. These settings will appear on the display (temperature and volume sides). To flush the appliance, **press and hold the inner tube flushing symbol for 3 seconds**. One cup of water will be dispensed, please discard it.

3. Cold water tank flushing:

If no cold water has been dispensed for a longer period of time (more than 7 days) or if the cooling system was turned off for extended period of time and then turned on again, a cold water tank flushing is needed to ensure a good hygiene level. 2 litres of water will be dispensed.



If the cold water tank flushing icon flashes in red, press and hold the flushing icon for 3 seconds to start flushing. Water amount needed for the flushing will be shown on the display (volume side). Please make sure that the water tank contains enough water and a sufficiently large container is placed under the outlet.

Manual cleaning function

Manual activation of self-cleaning program:

It is possible to activate the self-cleaning program manually if you have not used the appliance for a long time or want to clean the appliance but the last cleaning was less than 3 months ago.



Press and hold the **temperature '+' button for 3 seconds**, the inner pipe flushing icon and cold water tank flushing icon will start flashing.



Press and hold both buttons for 3 seconds to start the self-cleaning program. More about self-cleaning process in Section 8: 'Maintenance, Cleaning and Automatic self-cleaning'.

Manual deactivation of cleaning programs

Manual deactivation of inner pipe flushing:

For hygiene reasons, the inner pipe flushing icon starts flashing red if the

4. Manual emptying of the cold water tank



The cold water tank must be emptied when the appliance is switched off or unplugged for more than 24 hours, e.g. during holidays:

- 1) Empty the outside water tank.
- 2) Empty the cold water tank manually by pressing dispensing button for 10 seconds.
- 3) Unplug the appliance.

appliance has not been used for 24 hours. If you want to skip the flushing, just dispense water at ambient or hot water temperature and desired volume, the flushing indicator will turn off.

Manual deactivation of automatic self-cleaning:



If the appliance was switched off or unplugged for a short period of time, e.g. for cleaning (<24 hours), the automatic self-cleaning can be skipped by simultaneously pressing the preset volume buttons 'small' and 'large' for 3 seconds.

Caution:

If the appliance was switched off or unplugged for a longer period of time (>24 hours), BRITA strongly recommends to carry out the self-cleaning process as described in section 8: 'Maintenance, Cleaning, Automatic self-cleaning' to ensure the hygiene inside the appliance.

8 Cleaning of the appliance parts

Clean your appliance parts (water tank, funnel, lid, drip tray and grid) **regularly** and only by hand with cold or lukewarm water. The surfaces of your water dispenser can be cleaned with a neutral, non-abrasive cleaning agent. Please prevent water from entering the appliance during cleaning.

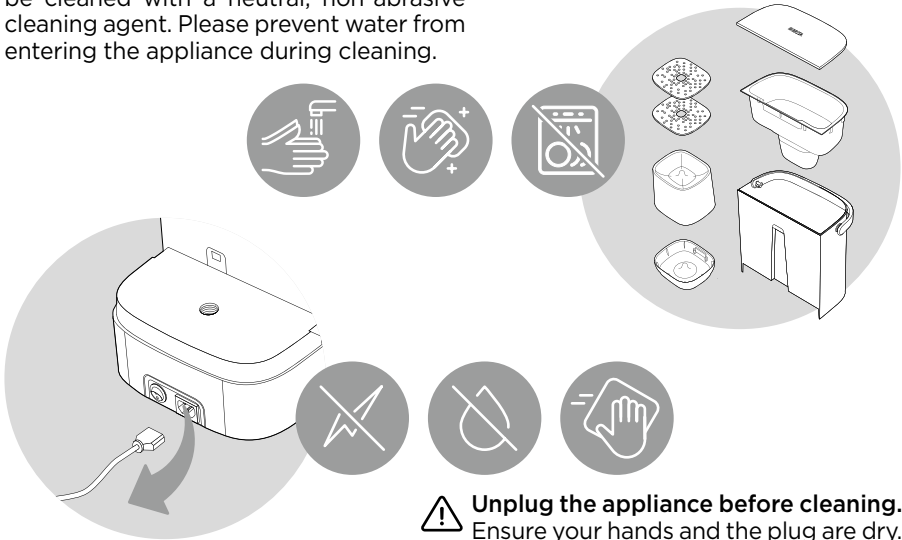

⚠ Unplug the appliance before cleaning.
Ensure your hands and the plug are dry.

9 Error codes

Error codes advise you that the appliance has a fault with certain components and are displayed via the 3 digital fields of the volume display.

Code	Description of defect	Possible cause	Solution
E1	Pump for hot water pipeline is defective	Pump is in short-circuit or open circuit.	If the error persists, please contact BRITA customer service.
E2	Pump for cold water pipeline is defective	Pump is in short-circuit or open circuit.	

E3	Pump for filling the cold-water tank is defective	Pump is in short-circuit or open circuit.	
E4	Temperature sensor at outlet is defective	Issue with NTC or the plug is not connected correctly.	
E5	Temperature sensor at inlet is defective	Issue with NTC or the plug is not connected correctly.	
E6	Temperature sensor at cold-water tank is defective	Issue with NTC or the plug is not connected correctly.	
E7	Environment temperature sensor is defective	Issue with NTC or the plug is not connected correctly.	
E8	UVC of hot water pipeline is defective	Issue with UVC module LED is defective, or the plug is not connected correctly.	
E9	UVC of cold water pipeline is defective	Issue with UVC module LED is defective, or the plug is not connected correctly.	If the error persists, please contact BRITA customer service.
E10	Static UVC in cold-water tank is defective	Issue with UVC module LED is defective, or the plug is not connected correctly.	
E11	Flowmeter is defective	Issue with the flow meter or the plug is not connected correctly	
E12	Liquid level in cold water tank is defective	Issue with the flow meter or the plug is not connected correctly	
E13	Heating function is not working	Issue with the flow meter or the plug is not connected correctly.	
E14	Cooling system is defective	The compressor or the cooling fan is defective.	
E16	Outlet high temperature protection	Pump for hot water pipeline is defective or the pipeline is stuck.	Restart the appliance and dispense ambient water. Try dispensing 95 °C water again. If the error persists, please contact BRITA customer service.
F1	Cooling system protection from high temperature	The heating dissipation is the issue.	Check if the inlet or outlet air holes are blocked, and ensure the cooling fan is working. The error will reset once the temperature drops below 43 °C. If the error persists, please contact BRITA customer service.

10 Disposal/Recycling



The crossed-out wheeled bin icon requires separate disposal for waste electrical and electronic equipment (WEEE).

Your water dispenser for home should not be disposed of with normal household waste. Follow your local authority guidelines for the separate collection of electrical and electron-

ic products. Correct disposal helps prevent negative consequences for the environment and human health. Please dispose the water dispenser for home and cartridge responsibly, following local guidelines. Ensure the cartridge remains unopened. Packaging and labels should be disposed of in accordance with local regulations.

Distributed by:

UK BRITA Water Filter Systems Ltd.

BRITA House, 9 Granville Way,
Bicester,
Oxfordshire, OX26 4JT, UK
BRITACare: 0344 7424800,
info@brita.net



www.brita.net